

LRM302207 Battery Assembly

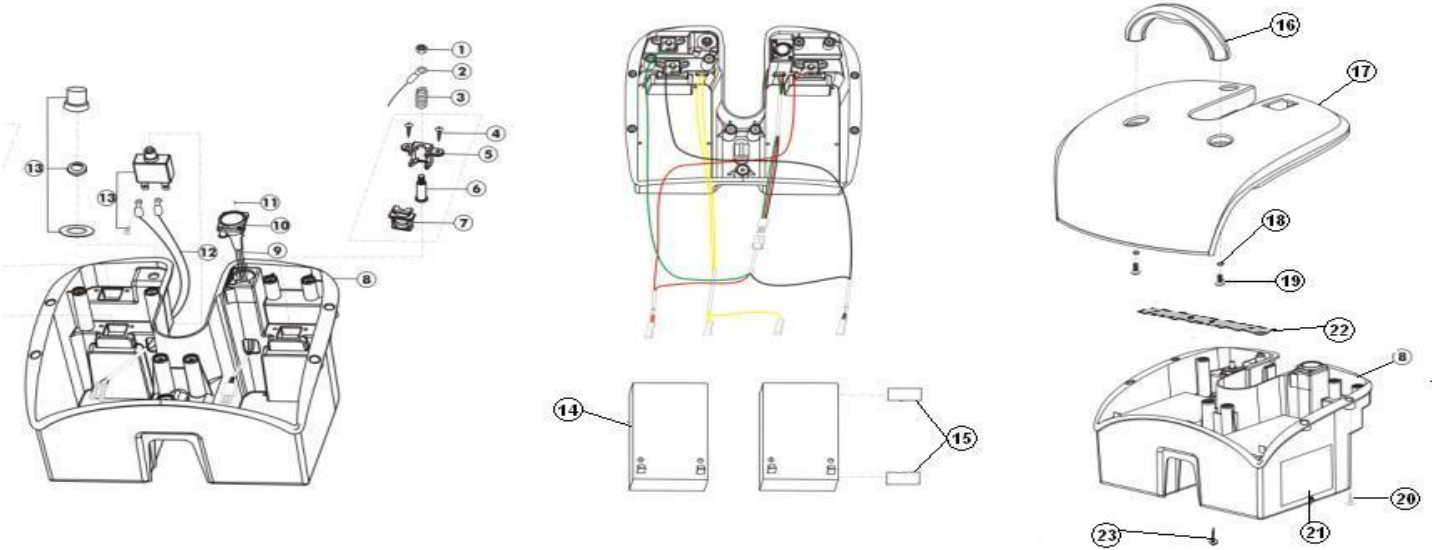

Item	Part Number	Description	Qty.
1	LRM302207-01	Nylon Nut, M5	3
2	LRM302207-02	Wire Module Of Battery, 14AWG	1
3	LRM302207-03	Compressed Spring,	3
4	LRM302207-04	Phillips Screws	6
5	LRM302207-05	Plastic Bracket Of Copper (Male)	3
6	LRM302207-06	Copper Post	3
7	LRM302207-07	Plastic Bracket Of Copper (Female)	3
8	LRM302207-08	Battery Plastic Box	1
9	LRM302207-09	Wire Module Of Charger Socket, 18AWG	1
10	LRM302207-10	Screws	1
11	LRM302207-11	Charger Socket	2
12	LRM302207-12	Wire Module Of Battery Pack, 14AWG	1
13	LRM302207-13	Circuit Breaker, 20A	1
14	LRM302207-14	Battery, DC12V*12AH	2

Item	Part Number	Description	Qty.
15	LRM302207-15	Twin Adhesive	2
16	LRM302207-16	Plastic Handle Of Battery Pack	1
17	LRM302207-17	Plastic Cover Of Battery Pack	1
18	LRM302207-18	Washer	2
19	LRM302207-19	Hex Socket Cap Screws	2
20	LRM302207-20	Phillips Screws	11
21	LRM302207-21	Label Of Circuit Illustration	1
22	LRM302207-22	Metal Fixed Piece	1
23	LRM302207-23	Self Tapping Screws	2