

LRM402207 Battery Assembly

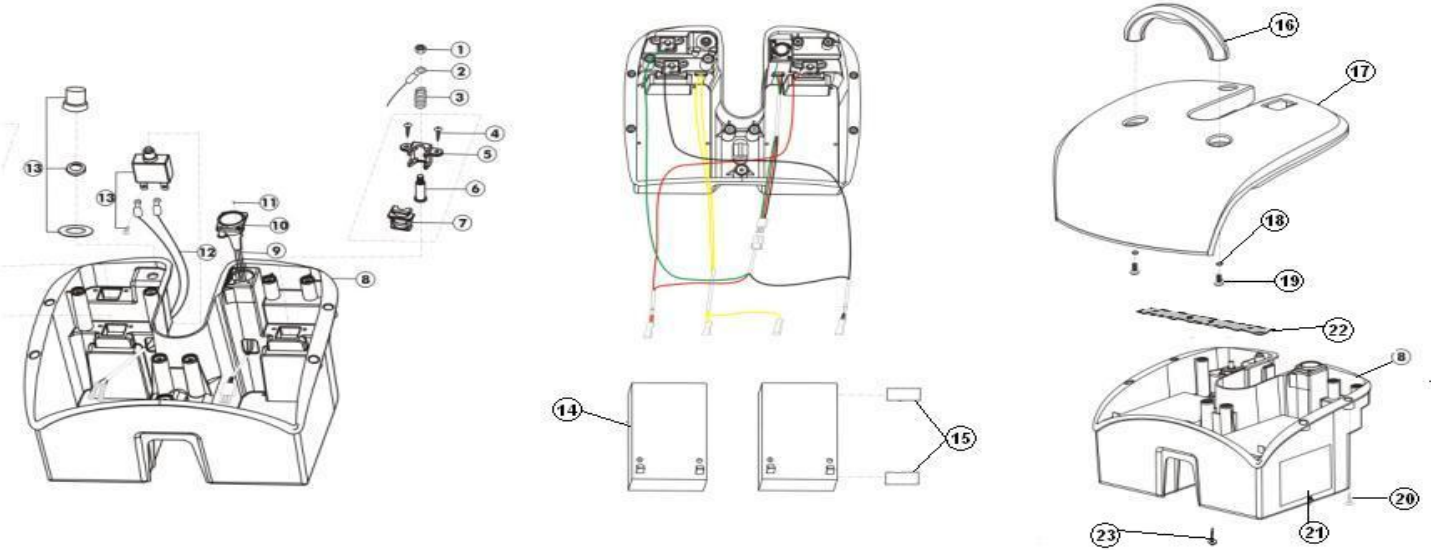

Item	Part Number	Description	Qty.
1	LRM402207-01	Nylon Nut, M5	3
2	LRM402207-02	Wire Module Of Battery, 14AWG	1
3	LRM402207-03	Compressed Spring	3
4	LRM402207-04	Phillips Screws	6
5	LRM402207-05	Plastic Bracket Of Copper (Male)	3
6	LRM402207-06	Copper Post	3
7	LRM402207-07	Plastic Bracket Of Copper (Female)	3
8	LRM402207-08	Battery Plastic Box	1
9	LRM402207-09	Wire Module Of Charger Socket, 18AWG	1
10	LRM402207-10	Screws	2
11	LRM402207-11	Charger Socket	1
12	LRM402207-12	Wire Module Of Battery Pack, 14AWG	1
13	LRM402207-13	Circuit Breaker, 20A	1
14	LRM402207-14	Battery, DC12V*12AH	2

Item	Part Number	Description	Qty.
15	LRM402207-15	Twin Adhesive	2
16	LRM402207-16	Plastic Handle Of Battery Pack	1
17	LRM402207-17	Plastic Cover Of Battery Pack	1
18	LRM402207-18	Washer	2
19	LRM402207-19	Hex Socket Cap Screws	2
20	LRM402207-20	Phillips Screws	11
21	LRM402207-21	Label Of Circuit Illustration	1
22	LRM402207-22	Metal Plate	1
23	LRM402207-23	Self Tapping Screws	2